



- ▲ MAKE SURE THE MODEL ON THE INSTRUCTION SHEET MATCHES YOUR VEHICLE.
- ▲ BE SURE TO READ ALL INSTRUCTIONS AND ILLUSTRATIONS BEFORE STARTING.

- ▲ DO NOT DISCARD PACKAGING UNTIL PRODUCT HAS BEEN SUCCESSFULLY INSTALLED.



Installation

1. Remove bolts and thread shields from the supplied clamps and install clamps in the desired position on the cage A-Pillar. Reinstall the bolts and thread shields. Finger tighten.
2. Thread the mirror into the clamp as far as it will go. It can be hand threaded but a 12mm open-end wrench can also be used. Use a 16mm wrench to tighten the locking nut against the clamp body (Thread locker can be used in this step to prevent movement.)
3. Use a 5mm hex key to tighten the clamp into its final position.
4. Adjust the break away mechanism bold to desired stiffness using a 5mm hex key.

Note: Over-tightening front bezel screws can cause glass to shatter. If using an aftermarket or factory optional windshield, flip the clamps around so that the thread shields and bolts are facing inside the vehicle. The low-profile side of the clamps will provide adequate clearance for the windshield.

Mirror Assembly & Maintenance

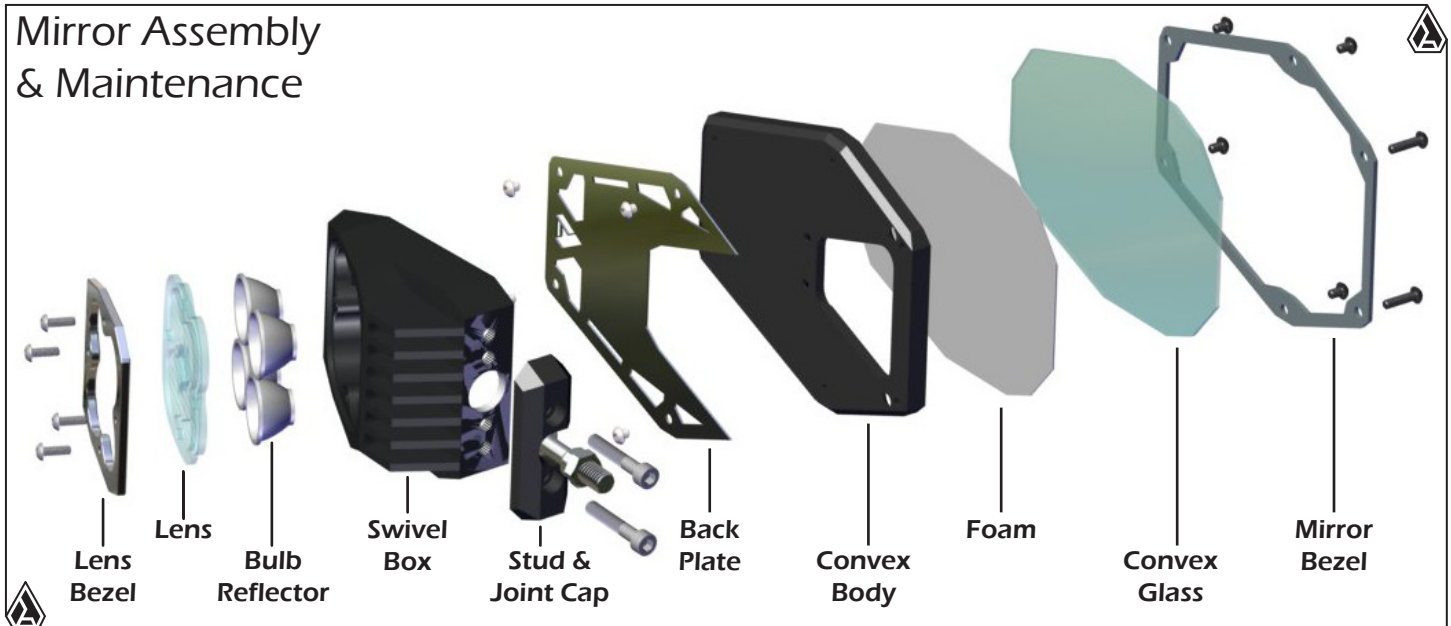

FROM THE TOOLBOX

- ▲ HEX KEY SET
- ▲ THREAD LOCKER (OPTIONAL)

IMPORTANT: Read instructions thoroughly prior to installation. Installation should be performed by a qualified professional. Over-tightening or uneven tightening of front bezel screws can break or distort the glass.

Installation

1. Place a towel on a table and lay out all parts of the mirror assembly.
2. Place the mirror mount into the mount housing.
3. Attach the mount housing assembly to the main housing plate. Use a small amount of thread locker if desired.
4. Depending on the model/style of mirror the foam material may be separated from the mirror. In this case, place the foam into the main mirror housing.
5. If the foam is attached to the mirror glass simply place the glass into the main mirror housing with the mirror side facing out.
6. Align the front bezel over the holes and finger tighten the screws until snug. Thread locker can be used in this step that screws do not need to be over tightened.

Nighthawk Light Box

For Maintenance or Replacement process, simply replace the Mirror Mount Housing and Bezel in the above steps. The only difference in assembly is that the Bezel must be placed in the Main Mirror Housing first, then the Light Box Housing will be installed on top of that. Once the box is installed and tightened down you will follow steps 4-8 in the above installation guide.



185 Bosstick Boulevard
San Marcos, CA 92069

Phone: 760-560-2252
Fax: 760-560-0383

FOR ANY LIGHT RELATED WARRANTY INQUIRIES
PLEASE CONTACT USING THE INFORMATION BELOW.

info@bajadesigns.com
www.bajadesigns.com

BaJa Designs Wiring Diagram

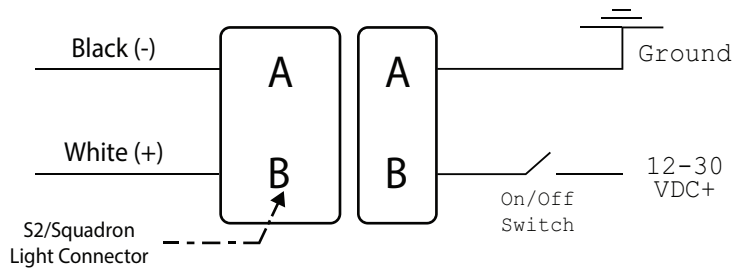

Lens Swap Instructions



- When installing a different lens, simply remove the (4) M4 screws using a 2.5mm allen wrench from the bezel.
- Carefully remove the front bezel and lens.
- Make sure the o-ring is properly fitted in the o-ring groove of the housing when installing the new lens.
- The o-ring is not directional, although the shape has been designed to match the housing profile groove.
- Once you have ensured the o-ring, lens, and bezel has been properly seated, begin tightening the (4) M4 screws.
- The bezel hardware should be torqued to 6.5 lb.in, in a "criss-cross" pattern.

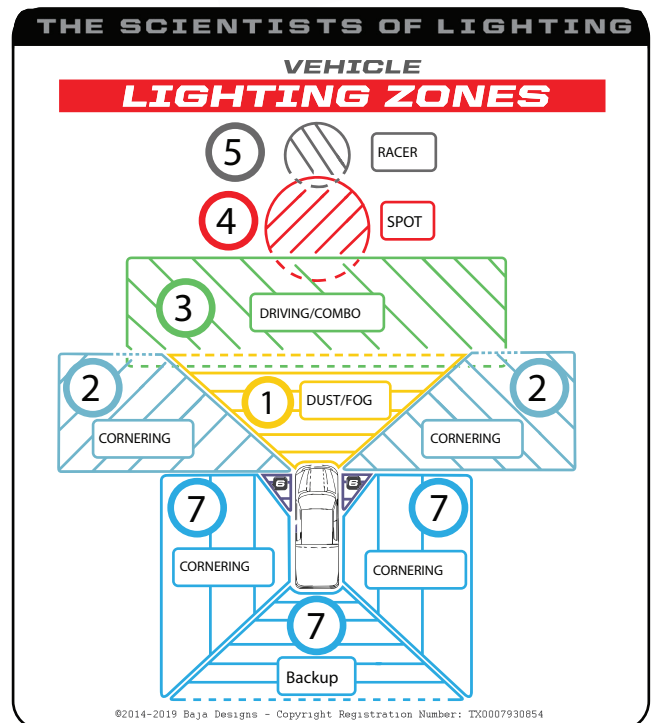

©2014-2019 Baja Designs - Copyright Registration Number: TX0007930854



bajadesigns®
THE SCIENTISTS OF LIGHTING

LIMITED LIFETIME WARRANTY

Baja Designs proudly offers a LIFETIME WARRANTY against manufacturer's defect on all of the products that we manufacture.

These are comprehensive warranties; other than the exclusions below – you're covered. If your LED or HID bulb burns out, you're covered. Additionally, cutting off our connector or changing your lenses does not automatically void your warranty.

EXCLUSIONS:

Installation errors, abuse, misuse or crash damage. You must be the original owner of the product and can supply proof of purchase.

Baja Designs manufactures its own products as well as resells products manufactured by others. Baja Designs makes no express or implied warranties on products not manufactured by Baja Designs including without limitation any warranties or merchantability and fitness for a particular purpose. We will however, pass on all warranties made by the manufacturer, who has sole responsibility for performing such warranties.

Baja Designs will pay the freight if your product is less than 90 days old, otherwise defective products must be returned to Baja Designs, Inc., freight prepaid. At our option, we will repair or replace items in question and return them at no charge. If the identical product is no longer available, we will replace with a similar product of equal value. Baja Designs Inc. will not be responsible for any indirect or consequential damages in connection with defective merchandise.

Items purchased through a Baja Designs authorized dealer must be returned through the dealer. Only available on LED auxiliary lights and product must be in sellable condition at MSRP. Product that has been damaged in any way after the original purchase date will be excluded from this guarantee

INDEMNIFICATION:

Buyer hereby acknowledges off-roading, racing and driving at night are dangerous activities and that the products and/or supplies purchased from Baja Designs are used in an inherently dangerous activity that may endanger life and limb; and in no event shall the seller, or seller's heirs and assigns, be held liable for consequential damages, nor shall seller's liability on any claim for damages arising out of or connected with the sale, delivery, or use of purchased products and/or supplies exceed the purchase price of the products and/or supplies.

MAKE SURE THAT ALL BOLTS AND NUTS ARE TIGHTENED AND ARE SECURE. PLEASE CONTACT ASSAULT INDUSTRIES FOR QUESTIONS REGARDING SPECIFICATIONS OR ANY OTHER QUESTIONS YOU MAY HAVE. THANKS!



Liability Statement

Assault Industries® products are designed to best fit user's ATV/UTV under stock conditions. Adding, modifying, or fabricating any factory or aftermarket parts will void any warranty provided by Assault Industries® and is not recommended. Assault Industries® products could interfere with other aftermarket accessories. If user has aftermarket products on machine, contact Assault Industries® to verify that they will work together.

Although Assault Industries® has thousands of satisfied customers, user should be aware that installing lift kits, long travel, or suspension kits, tires, etc. will change the ride of machine and may increase maintenance and part wear. Operating any off-road machine while, or after, consuming alcohol and/or drugs increases risk of bodily harm or death. No warranty or representation is made as to this product's ability to protect user from severe injury or death. Assault Industries® urges operators and occupants to wear a helmet and appropriate riding gear at all times.

By purchasing and installing Assault Industries® products, user agrees that should damages occur, Assault Industries® will not be held responsible for loss of time, use, labor fees, replacement parts, or freight charges. Assault Industries®, nor any 3rd party, will not be held responsible for any direct, indirect, incidental, special, or consequential damages that result from any product purchased from Assault Industries®. The total liability of seller to user for all damages, losses, and causes of action, if any, shall not exceed the total purchase price paid for the product that gave rise to the claim.

Assault Industries® will warranty only parts provided by Assault Industries®. Any damage or problems with OEM housings, bearings, seals, or other manufacturers' products will not be covered by Assault Industries®. Assault Industries® parts and products are not warranted if item was not installed properly, misused, or modified.

Installing, adding, modifying, or fabricating any factory or aftermarket product to your ATV/UTV may violate certain local, state, and federal laws. Be advised that laws vary depending on town, city, county, state, etc. Use of certain products on public streets, roads, or highways may be in violation law. The Buyer is solely and exclusively legally and personally responsible for any violation of the law by the installation or use of the product. You must abide by all local, state, and federal laws, including but not limited to vehicle safety, traffic laws, and ordinances. It is your responsibility to know the laws and how they apply to you.

The Buyer is responsible to fully understand the capability and limitations of his/her vehicle according to manufacturer specifications, warnings and instructions and agrees to hold Assault Industries® harmless from any damage resulting from failure to adhere to such specifications, warnings and/ or instructions. The Buyer is also responsible to obey all applicable federal, state, and local laws and ordinances when operating his/her vehicle while using this product, and the Buyer agrees to hold Assault Industries® harmless from any violation thereof.

LEAVE US FEEDBACK

Visit Assaultind.com and leave a review of your product purchase. We appreciate your opinion.....
.....even if you're wrong! 😊

NEED ADDITIONAL HELP?

Check out our YouTube channel
Call us : (714) 799-6711
Monday - Friday: 8am-5pm
Email: sales@assaultind.com